

## Wichard Forged CE Stainless Steel Captive Pin D shackles



Forged CE stainless steel captive pin D shackle.

Captive pin 'patented'.

Not only are these self-locking, the pin is also connected to the body at all times, even when fully opened. Consequently, there is no more risk of seeing it fall in the water, which would make the shackle unusable. These shackles can therefore be fitted completely safely using just one hand.

Hot dropped forged from a single piece of stainless steel, adding strength and consistency of manufacture for total security and reliability. The technical characteristics of every Shackle is closely controlled and tested before, during and after the manufacturing process.

Manufactured from AISI 316 stainless offering excellent corrosion resistance, especially in marine environments.

**CE marked** in accordance with the Machines Directive 2006/42, these Wichard products can be used as lifting accessories. Each product displays the following information:

- Working Load Limit (WLL) = 5:1 safety factor of the break load,
- CE marking,
- Product origin,
- Manufacturer's logo.

Material and conformity certificates available on request.

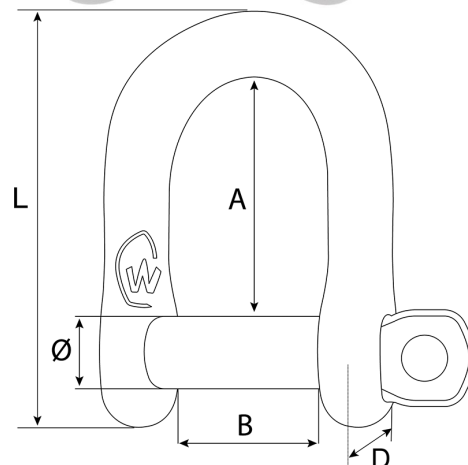

| Part    | Pin Ø mm | L mm | A mm | B mm | Pin Thread Ø mm | D mm | Work Kg | BL Kg | WLL Kg (5:1) | Weight Kg |
|---------|----------|------|------|------|-----------------|------|---------|-------|--------------|-----------|
| WD-1401 | 4        | 24   | 13   | 8    | 5               | 9    | 320     | 1000  | 200          | 0.009     |
| WD-1402 | 5        | 27   | 16   | 10   | 6               | 11   | 480     | 1500  | 200          | 0.016     |
| WD-1403 | 6        | 36   | 20   | 12   | 7               | 14   | 680     | 2200  | 440          | 0.028     |
| WD-1404 | 8        | 47   | 26   | 16   | 9               | 18   | 1000    | 3600  | 720          | 0.061     |
| WD-1405 | 10       | 58   | 33   | 20   | 11              | 21   | 1520    | 5200  | 1040         | 0.114     |
| WD-1406 | 12       | 69   | 39   | 24   | 13              | 24   | 2080    | 7000  | 1400         | 0.188     |