



Mantus M1 Stainless- Steel Anchors

Intro

The Mantus M1 Stainless-Steel Anchors feature a 2205 Duplex shank and 316L stainless-steel fluke. The surface is hardened by 'shot peening' and is then electro-polished to provide maximum corrosion resistance, the result an incredibly durable, high-performance long-lasting anchor that has a beautifully polished finish.

This quick setting high-performance cruising and powerboat yacht anchor, 'DIGS LIKE NO OTHER' and is easily stowable. The Mantus M1 Stainless-Steel Yacht Anchor breaks down for easy storage, so you can store one or two as spares without needing to take up valuable boat space.

Description

The Mantus M1 Stainless-Steel Anchor is designed to dig like no other and will penetrate dense, grassy bottoms and set with unparalleled holding power. When tested, our anchors set faster and deeper than any other tested anchor, including Rocna, Manson Supreme, Bulwagga, Fortress, Bruce, CQR and Danforth anchors.

Mantus M1 anchors set perfectly every time, the roll bar delivers the anchor at the optimum penetration angle and the sharp-headed nose is precision machined to achieve the ideal chisel shape to achieve maximum penetrating power.

The anchors fluke design is shaped to present the maximum area possible to the sea floor and then provide optimum resistance enabling the highest holding power possible whether on a soft seabed, or on hard or weedy sea floors. The M1 will remain stable and buried once in position and will not 'roll out' if reversed or veered.

Manufactured and formed from the highest quality 316L stainless-steel which is hardened by 'shot peening' and then electro-polished to provide maximum corrosion resistance. The 2205 Duplex shank and shank boot are welded from top and bottom and are securely bolted with the roll bar to the fluke with oversized ASTM certified stainless-steel bolts with a large margin to ensure safety. 4 bolts are used with a single bolt sufficient to handle the maximum expected load on the anchor.

Mantus simply offer the best boat anchors available, for every requirement whether a long-range cruiser, racing yachtsmen, or daysailer. The Mantus M1 quickly sets is stowable and breaks down for easy storage, enabling you to store one or two as spares without needing to take up valuable boat space.

Features

- Formed out of high-quality 316L stainless-steel.
- Surface hardened by shot-peening.
- Surfaces electro-polished to provide maximum corrosion resistance.
- Highly polished aesthetic.
- 2205 Duplex shank and shank boot are welded from top and bottom.
- Shank and roll bar are bolted to the fluke.
- ASTM certified stainless-steel bolts are oversized with a large margin to ensure safety.



- Although the shank is attached to the fluke with 4 bolts, a single bolt has sufficient strength to handle the maximum expected load on the anchor.
- Sharp-headed nose is precision machined to achieve the perfect chisel shape to achieve maximum penetrating power.
- In the carbon steel version, every part of the anchor system is hot-dip galvanized for corrosion protection. (All shanks are HT ASTM 514 Steel and flukes are mild steel A36 equivalent).

Stainless Steel Bolts

** working load is 1/4th of the breaking strength.*

Bolt Size	316 SS Bolt - Tensile Strength (lbs)	Shank/Fluke Joint Breaking Strength (lbs)	Shank/Fluke Joint Working Load* (lbs)	Anchor Size/Model (4 bolts are used in Shank/Fluke Joint)
1/4	3,750	15,000	3,750	8 lbs
3/8	8,250	33,000	8,250	13lbs/25 lbs
1/2	15,000	60,000	15,000	35 lbs/45 lbs
5/8	23,000	92,000	23,000	55 lbs/65 lbs/85 lbs
3/4	33,000	132,000	33,000	105 lbs/ 125 lbs/ 175 lbs

What's Included

- Anchor of choice
- Bolts, Washers and Nuts are provided with every Mantus M1 Anchor

Specification

When making sizing recommendations for a cruising anchor we are referring to the needs of a cruising boat spending most of its time on anchor. In doing so we try to envelope high sustained winds (50 kts) and assume poor holding conditions (low viscosity bottoms). Some may think these recommendations to be too conservative especially when compared to sizing tables from other manufacturers. Companies often make claims of superior anchor efficiency, stating that their small anchor X will outperform a much heavier anchor from their competitors and often use sizing charts as a marketing tool to that end, recommending anchors and anchor systems that are dangerously undersized for their intended use. Comparing surface area can be a good judge for potential holding capability. Our anchor sizing recommendations are presented in the tables below and divided in three categories: 'Day Anchor' category is recommended for lighter use, expected winds under 30 knots, 'Cruising Anchor' for winds under 50 knots and finally, 'Storm Anchor' recommendations are intended for winds above 50 knots. These recommendations are made assuming the worst-case scenario, a poor holding bottom and thus may seem conservative, but we believe are accurate.



Anchor Size Guide:

Anchor Size	Day Anchor recommended for winds < 30 knots	Cruising Anchor recommended for winds < 50 knots	Storm Anchor recommended for winds > 50 knots	Blade Surface Area cm ²
2.5 lbs	0-16 feet < 1,000 lbs			160
8 lbs	16-20 feet < 3,000 lbs	0-14 feet < 1,000 lbs	0-12 feet < 800 lbs	360
13 lbs	20-25 feet < 5,000 lbs	16-20 feet < 3000lbs	12-16 feet < 1000 lbs	570
17 lbs	25-30 feet < 11,000 lbs	20-25 feet < 5000lbs	16-20 feet < 3000 lbs	680
25 lbs	30-35 feet < 15,000 lbs	25-30 feet < 11,000 lbs	20-25 feet < 5000 lbs	800
35 lbs	35-39 feet < 20,000 lbs	30-35 feet < 15,000 lbs	25-30 feet < 11,000 lbs	1000
45 lbs	39-43 feet < 30,000 lbs	35-39 feet < 20,000 lbs	30-35 feet < 15,000 lbs	1260
55 lbs	43-45 feet < 40,000 lbs	39-43 feet < 30,000 lbs	35-39 feet < 20,000 lbs	1400

Dimensions and Fit:

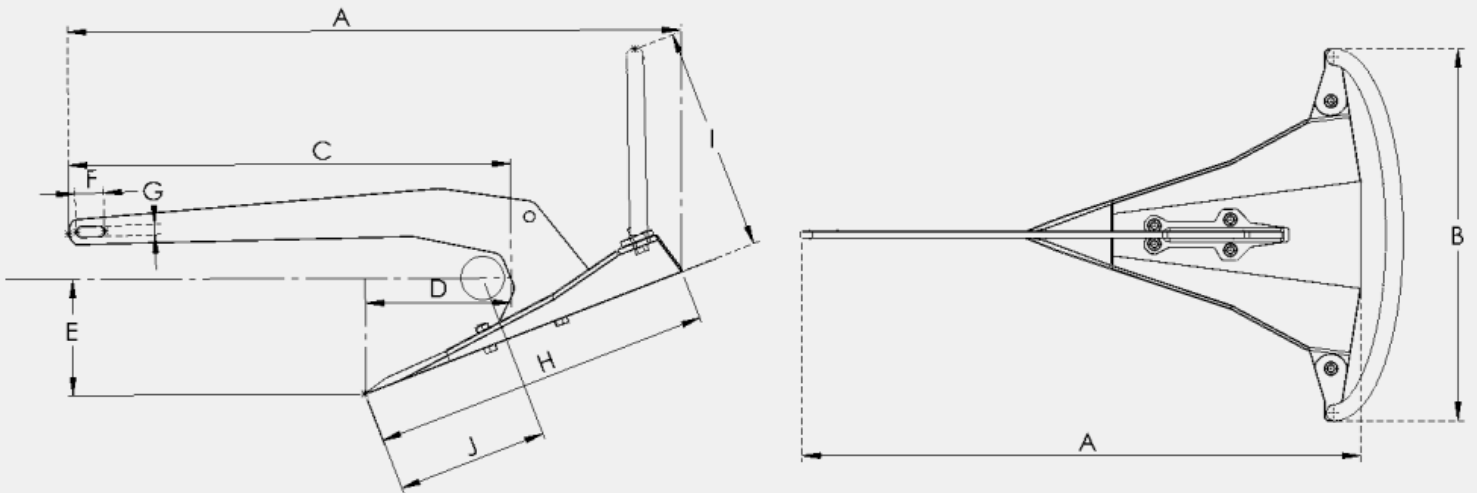

M1 MODEL DIMENSIONS (IMPERIAL)

	A	B	C	D	E	F	G	H	I	J
2.5 lbs	17	10.2	11.8	4.0	3.2	0.8	0.3	9.3	6.1	4.1
8 lbs	22	13.0	15.1	5.1	4.1	1.0	0.4	11.9	7.9	5.3
13 lbs	26	15.9	18.4	6.2	5.0	1.2	0.4	14.5	9.6	6.5
17 lbs	29	17.5	20.4	6.9	5.5	1.3	0.5	16.0	10.6	7.1
25 lbs	31	19.0	22.0	7.4	5.9	1.5	0.5	17.3	11.4	7.7
35 lbs	35	21.1	24.5	8.3	6.6	1.6	0.6	19.3	12.7	8.6
45 lbs	39	23.7	27.5	9.3	7.4	1.8	0.7	21.6	14.3	9.6
55 lbs	42	25.4	29.4	10.0	7.9	1.9	0.7	23.2	15.3	10.3



M1 MODEL DIMENSIONS (METRIC)

	A	B	C	D	E	F	G	H	I	J
1.1 kg	427	259	300	102	81	20	7	236	156	105
3.6 kg	546	331	384	130	103	25	9	302	200	135
5.9 kg	666	403	468	158	126	31	11	368	243	164
7.7 kg	735	446	517	175	139	34	12	407	269	181
11.4 kg	795	482	559	189	150	37	13	440	290	196
15.9 kg	884	536	622	210	167	41	15	489	323	218
20.5 kg	993	602	699	236	188	46	17	550	363	245
25.0 kg	1063	644	747	253	201	49	18	588	388	262